

MALTBY EAST TOWNS & VILLAGES - OUTLINE CONCEPT

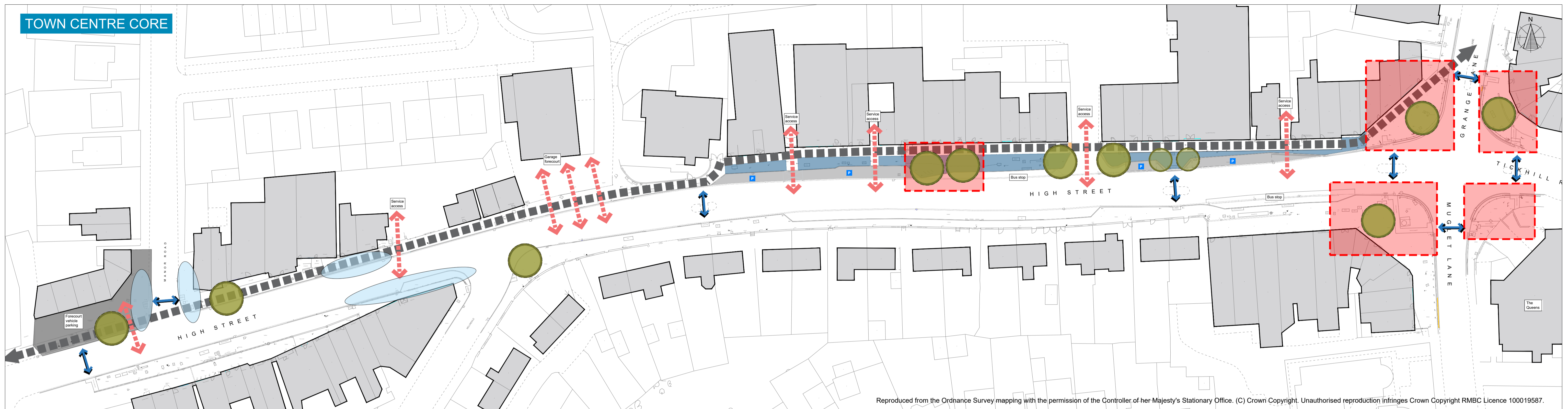

Reproduced from the Ordnance Survey mapping with the permission of the Controller of Her Majesty's Stationary Office. (C) Crown Copyright. Unauthorised reproduction infringes Crown Copyright RMBC Licence 100019587.

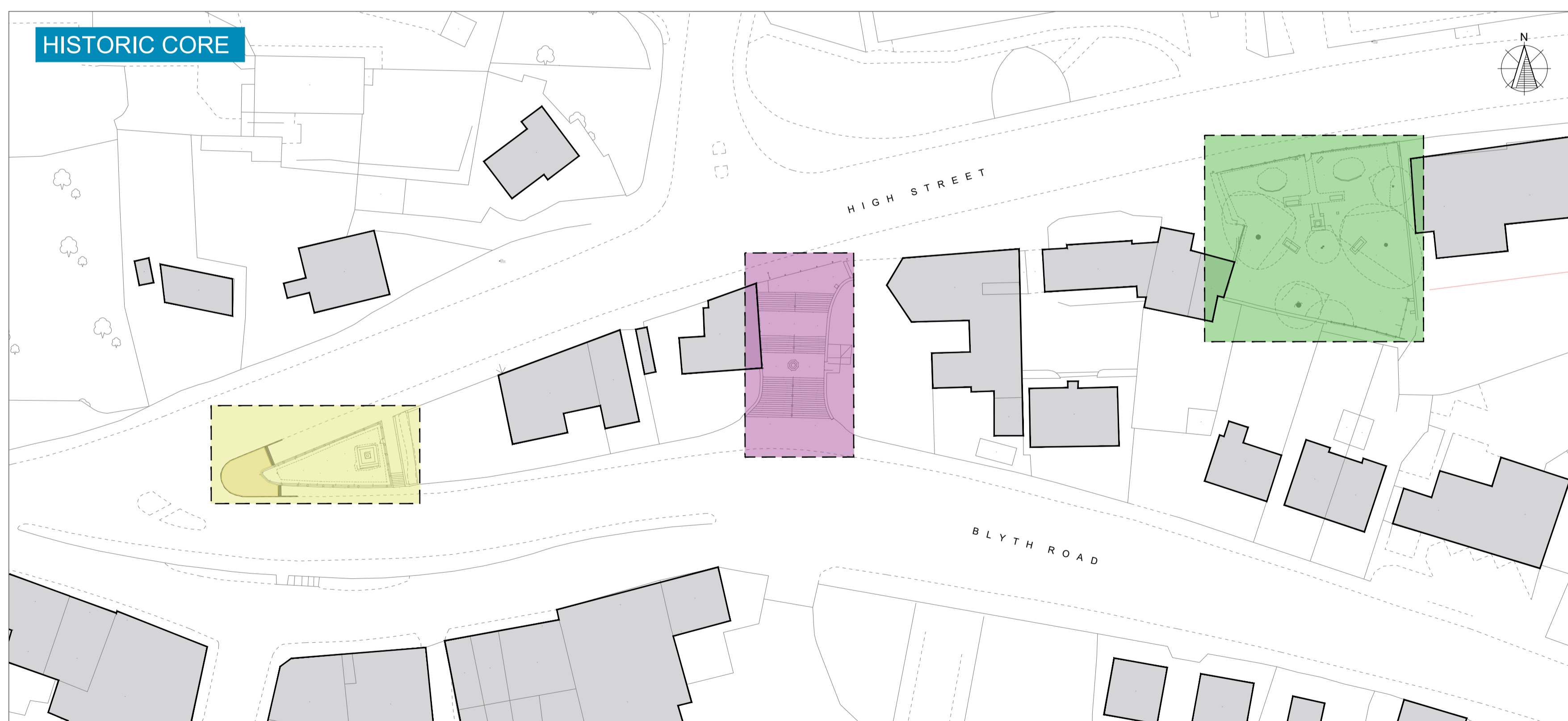

LEGEND FOR THE PLAN

HIGH STREET

- Key intervention location:** Visually prominent, wide pedestrian area, opportunity for maximising impact.
- Potential greening:** Space for meaningful planting proposals including opportunity for trees.
- Primary pedestrian route:** Strong corridor for unimpeded pedestrian movement.
- Upgraded pedestrian zone:** Visually prominent, high quality material pallet with opportunity for concentration of street furniture.
- Low key improvements:** Visually prominent areas but with minimal design interventions.
- Wide forecourt:** Low key improvements to uplift current degraded appearance.
- Existing lay-by parking:** Retain for retail benefits.
- Vehicle crossing pedestrian zone:** Drop crossing allowing possible vehicular access across footway.
- Pedestrian crossing:** Uplifted quality where possible to enhance pedestrian experience at busy road crossing points.

HISTORIC CORE

- Memorial Garden:** Small, formal open space with seating and historical references.
- Don John steps and memorial:** Grand flight of steps with imposing limestone walling and historic references.
- Blyth Road Junction:** Visually prominent gateway corner with historic references.

Aims

The major road corridor which runs through the busy shopping area of Maltby High Street is lacking coherent design, is randomly scattered with visually unremarkable street furniture and signage and has had little recent investment in the public realm leaving the area well worn and visually unattractive. The main aim of this Towns and Villages investment is to enhance the user experience by creating a more attractive and vibrant urban environment for both pedestrians and road users through various interventions including;

- the creation of a clear, safe pedestrian route along the shop frontages including de-cluttering.
- resurfacing to improve the footway condition together with the use of higher quality decorative paving along the roadside edge of the footway to lift the quality of the streetscene.
- provide new seating and planted areas to form a pleasant, green environment along the High Street for pedestrians. Introduction of trees where possible to maximise the visual impact and bring a multitude of benefits that trees can provide to the urban environment.
- all metalwork to match forming a simple and consistent furniture pallet. Existing galvanised sign posts and light columns to be painted black to enhance their visual quality and match new furniture.

Rotherham Metropolitan Borough Council
Regeneration & Environment
Strategic Director:
Andrew Bramidge MA Urban Regen

Rotherham Metropolitan Borough Council
Regeneration & Environment
Riverside House, Main Street,
Rotherham S60 1AE

Client:
RiDO

Rev.	Description	Date	Initial	Chd.	Drawn	Date	Chd. by
					APB	July 2021	SH

Project	Maltby East Towns and Villages		
Title	Outline Concept		
Dwg. No.	L5109-100	Rev	
Scales (if A1)	1:500		