

MALTBY EAST TOWNS & VILLAGES - TOWN CENTRE CORE

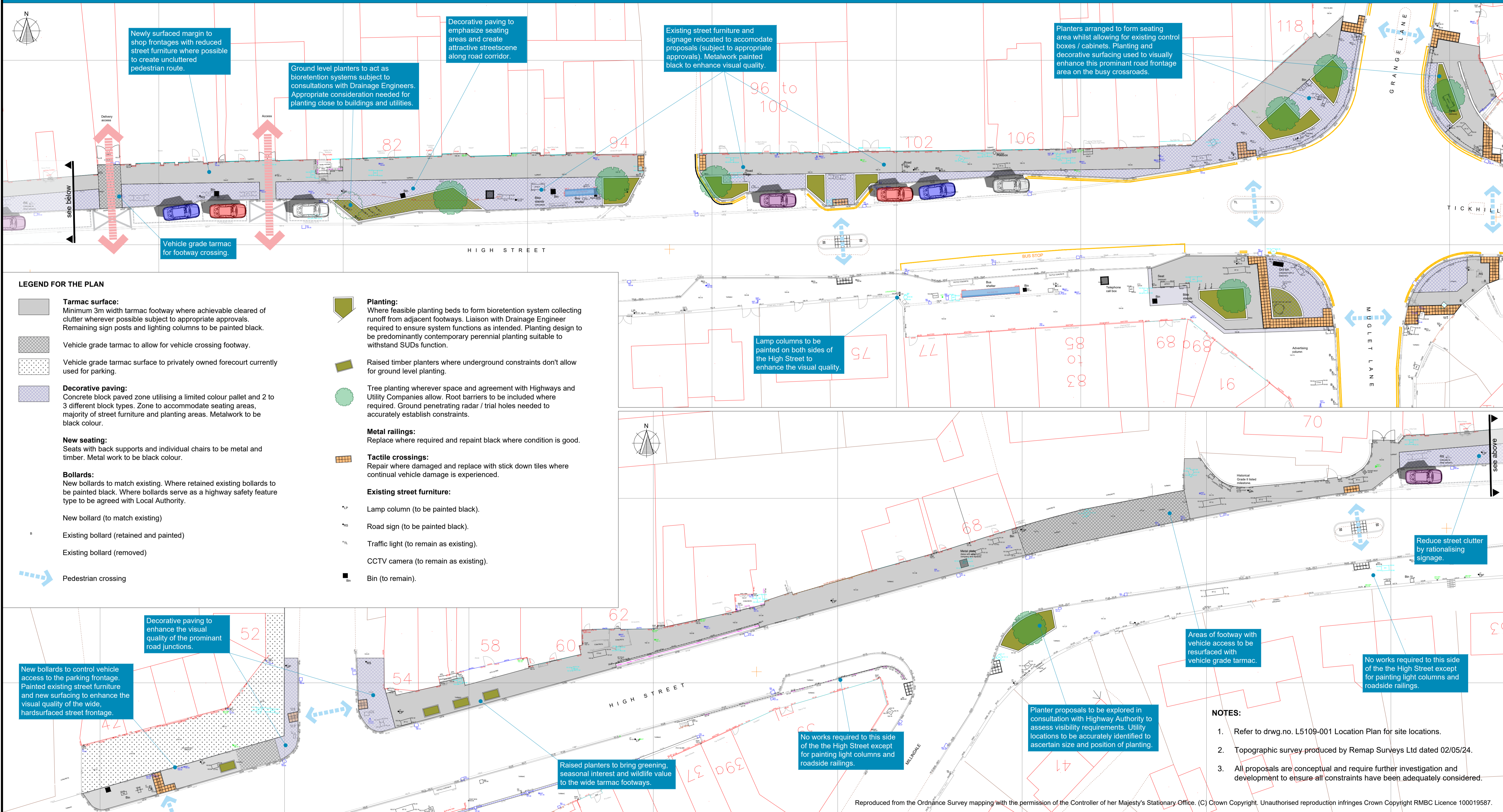

Reproduced from the Ordnance Survey mapping with the permission of the Controller of her Majesty's Stationary Office. (C) Crown Copyright. Unauthorised reproduction infringes Crown Copyright RMBC Licence 100019587.



Rotherham Metropolitan Borough Council
Regeneration & Environment
 Riverside House, Main Street,
 Rotherham S60 1AE

Client:
 RiDO

Project
Maltby East Towns and Villages
 Title
Concept Proposals - Town Centre Core

Dwg. No. L5109-102 Rev

Scales (if A1) 1:250

Rev.	Description	Date	Initial	Chd.	Drawn	Date	Chd. by
	APB	July 2024		SH			

Strategic Director:
 Andrew Bramidge MA Urban Regen